



馈通交流P系列滤波器 Feed through AC P Series Filter



产品特征 Features

- 具有优异的高频传导干扰抑制能力Excellent suppression performance in high frequency
- 高可靠性
High reliability
- 便于安装
Easy to mount

应用场合 Applications

应用在电信设备，医疗设备等，特别是在要求性能良好的高频段。

Application at telecoms equipment and especially where good performance at high frequencies is prime requirement.

规格表 Specification

产品型号 Filter P/N	端接方式 I/O connection		额定电流 Current rating at 40°C	额定电压 Max. operating voltage	耐压等级 Hipot test voltage	气候类别 Climatic category
	输入 Input	输入 Input				
FLTPD13-10SE			10A	115/250VAC	3000VDC (LINE/CASE)	25/85/21
FLTPF22-16SE			16A	115/250VAC	3000VDC (LINE/CASE)	
FLTPH23-63SE			63A	115/250VAC	3000VDC (LINE/CASE)	

差损曲线 Insertion Loss

插入耗损是参考 CISPR17标准,在50Ω系统条件下测定的 (Per CISPR 17, Z=50Ω)

—— 共模 CM common mode

FLTPD13-10SE

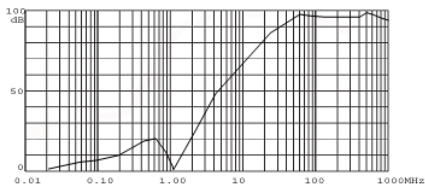

FLTPF22-16SE

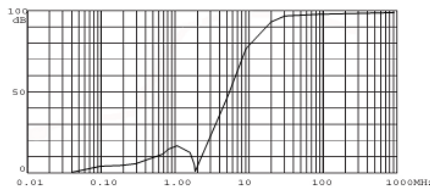

FLTPH23-63SE

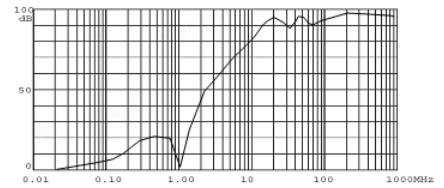

外形尺寸图 Dimensional Drawing (unit: mm)

FLTPD13-10SE

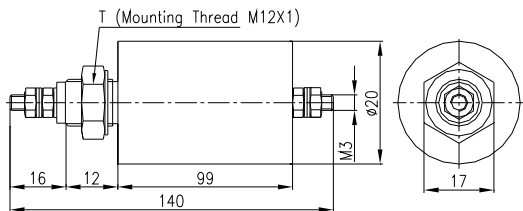

FLTPF22-16SE

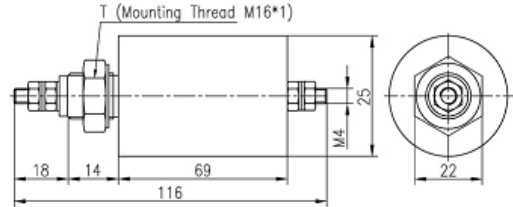

FLTPH23-63SE

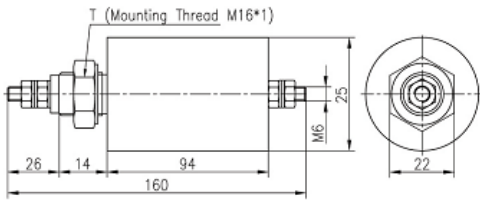

电路原理图Circuit diagram

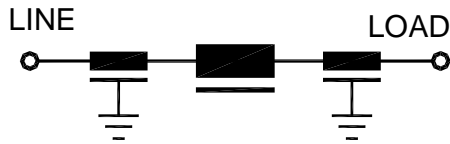



馈通直流P系列滤波器 Feed through DC P Series Filter



产品特征 Features

- 具有优异的高频传导干扰抑制能力 Excellent suppression performance in high frequency
- 大电流，高可靠性
- High current capacity and High reliability
- 便于安装 Easy to mount

应用场合 Applications

电信、医疗设备、汽车电子、军用设备、电子系统射频干扰等。

Telecommunication , Medical equipment, Automobile electronic, Military industry, RFI electronic systems.

规格表 Specification

产品型号 Filter P/N	端接方式 I/O connection		额定电流 Current rating at 40°C	额定电压 Max. operating voltage	耐压等级 Hipot test voltage	气候类别 Climatic category
	输入 Input	输入 Input				
FLTP72D-65A			65A	200VDC	1650VDC(LINE/CASE)	25/85/21
FLTP70D-75A,			75A	200VDC	1800VDC(LINE/CASE)	
FLTP70D-100A			100A	200VDC	1800VDC(LINE/CASE)	
FLTP76D-230A			230A	400VDC	2121VDC(LINE/CASE)	

差损曲线 Insertion Loss

插入耗损是参考 CISPR17标准,在50Ω系统条件下测定的 (Per CISPR 17, Z=50Ω)

—— 共模 CM common mode

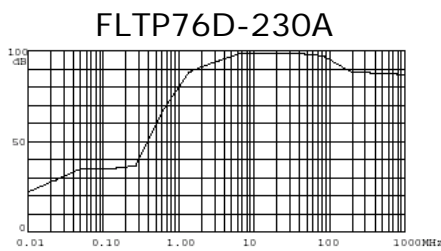
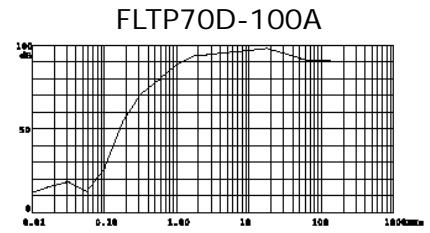
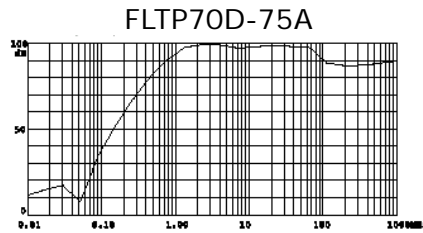
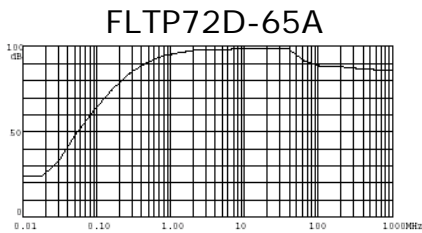

外形尺寸图 Dimensional Drawing (unit: mm)

FLTP72D-65A

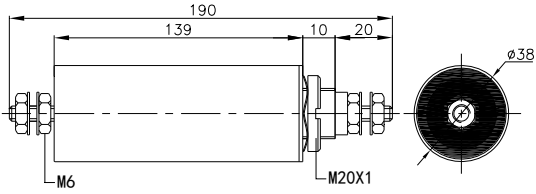

LTP70D-75A

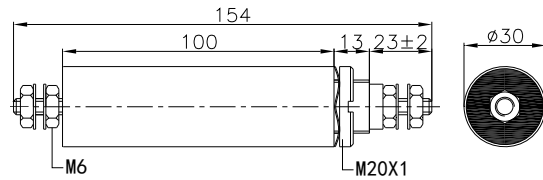

FLTP70D-100A

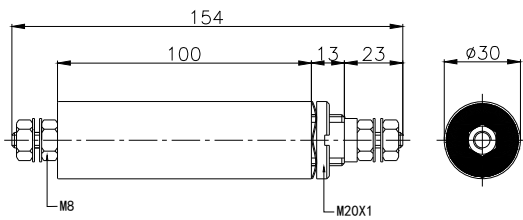

FLTP76D-230A

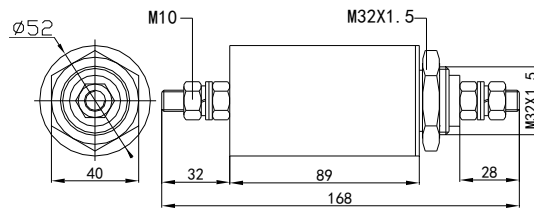

电路原理图 Circuit diagram

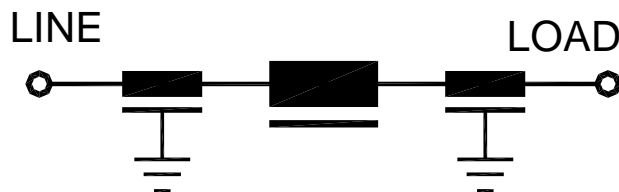



馈通直流C系列滤波器 Feed through DC C Series Filter



产品特征 Features

- 具有良好的高频传导干扰抑制能力。
Good EMI suppression performance in high frequency
- 大电流，高可靠性，小型化。
High current capacity ,High reliability and Miniature
- 便于安装
Easy to mount

应用场合 Applications

用于电信、电子系统射频干扰等。
Application at telecommunication and RFI electronic systems.

规格表 Specification

产品型号 Filter P/N	端接方式 I/O connection		额定电流 Current rating at 40°C	额定电压 Max. operating voltage	耐压等级 Hipot test voltage	气候类别 Climatic category
	输入 Input	输出 Output				
FLTC12D-20A			20A	200VDC	1000VDC(LINE/CASE)	25/85/21
FLTC12D-50A			50A	200VDC	1000VDC(LINE/CASE)	
FLTC15D-65A			65A	200VDC	1700VDC(LINE/CASE)	
FLTC16D-100A			100A	200VDC	1700VDC(LINE/CASE)	
FLTC18D-200A			200A	200VDC	1700VDC(LINE/CASE)	

差损曲线 Insertion Loss

插入损耗是参考 CISPR17标准,在50Ω系统条件下测定的 (Per CISPR 17, Z=50Ω)

—— 共模 CM common mode

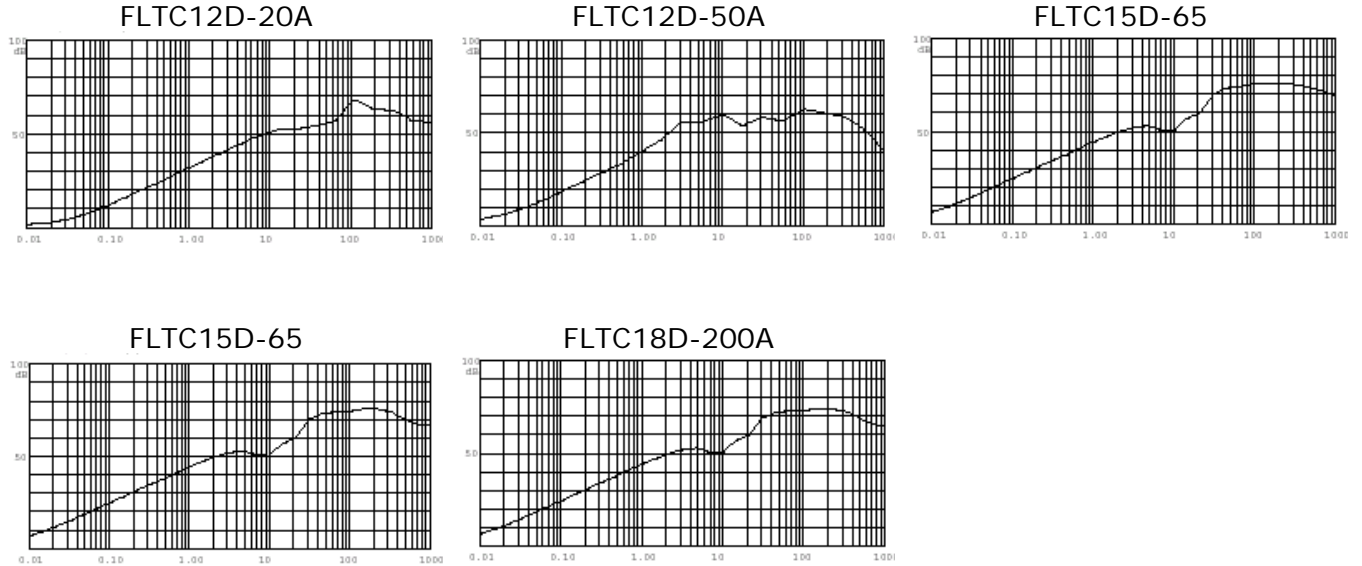

外形尺寸图 Dimensional Drawing (unit: mm)

FLCH64-6A

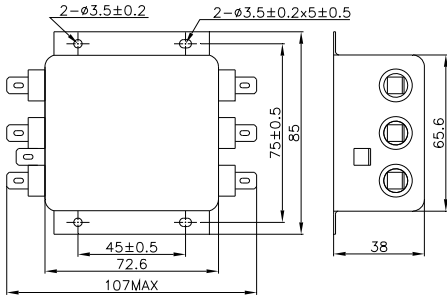

FLEH85-15A

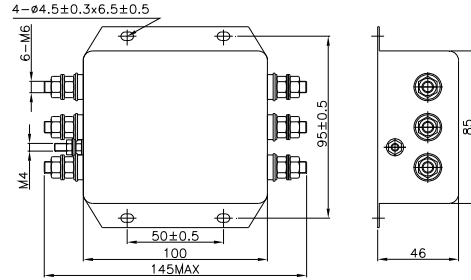

FLFH06-35A FLFH06-50A

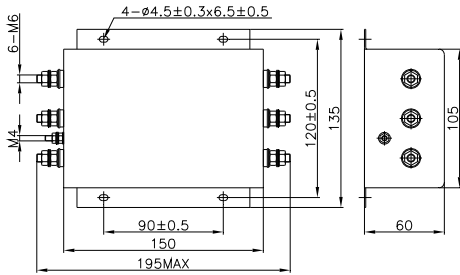

FLSH06-60A

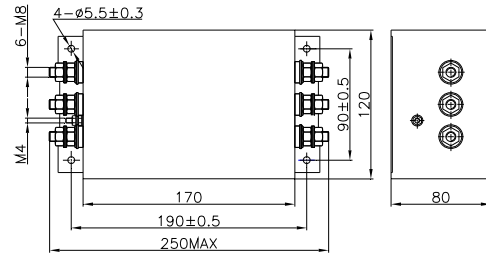

电路原理图 Circuit diagram

